

IMBJR



Manual de Instruções em Português

LEÃO MODELISMO LTDA CNPJ - 13.462.342/0001-75
Avenida Cerro Azul, 2688
CEP 87010-055 - Maringá - PR
Suporte e atendimento ao cliente - 44 3023-0368
WWW.LEAOMODELISMO.COM.BR



Parabéns por adquirir o novo M8JR RTR. Para usar o carro, Será necessário checar alguns procedimentos.

1 Ferramentas

■ Chave de ajuste de link



■ Chave estrela (4mm, 5mm, 5.5mm & 7mm)

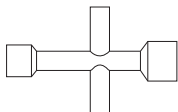

■ Chave estrela (7, 8, 10, 12 & 17mm)

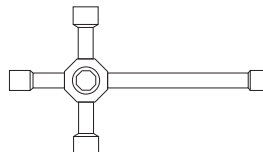

2 Algumas ferramentas opcionais

■ Alicate



■ Compasso



■ Estilete



■ Fita Dupla Face

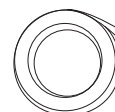

■ Furador de Bolha



■ Tesoura de Bolha

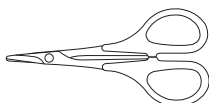

■ Trava Rosca



■ Alicate pequeno

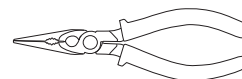

■ Chave de fenda Pequena



■ Chave Alem 1.5mm

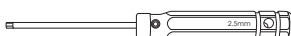

■ Chave Alem 2.0mm

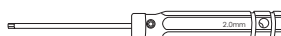

■ Chave Alem 2.5mm



■ Combustível Byron Fuels 20/12
20% nitro e 12% Óleo

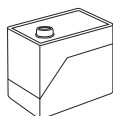

■ Pilhas alcalinas para radio
tamanho AA

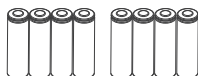

■ Caixa de partida
(Opcional)

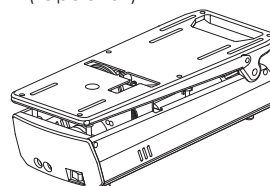

■ Carregador de Baterias para o
pack do carro(6V 650mah)

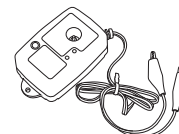

■ Aquecedor de Vela
DYN2300

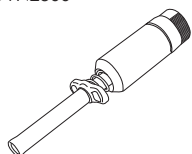

■ Aumotolia Byron
500c.c.



■ Oleo de filtro de arl



■ Tinta para Bolha



■ Vela modelo Standard



■ H.A.R.D. 6v 1500mah NiMH



3 Sugestões de Ferramentas

■ Mesa de setup para Buggy escala 1/8

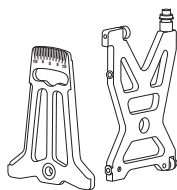

■ TM 1/8 Setup Board (500x480mm)

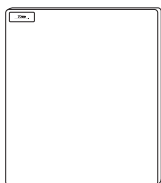

■ Chave de boca de 10mm



■ Chave de boca 5.5mm



4 Acessórios TEAM MAGIC

■ Boné TM



■ Camiseta TM



■ Mala de Radio



■ Mala de Caixa de Partida



■ Mala para Carro e Acessórios

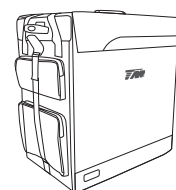

01 Posição da Antena

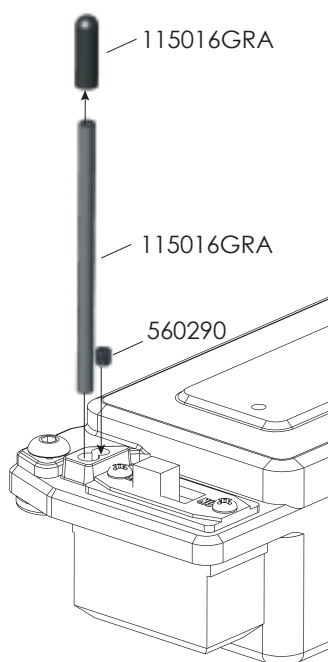

02 Posição do Filtro de AR

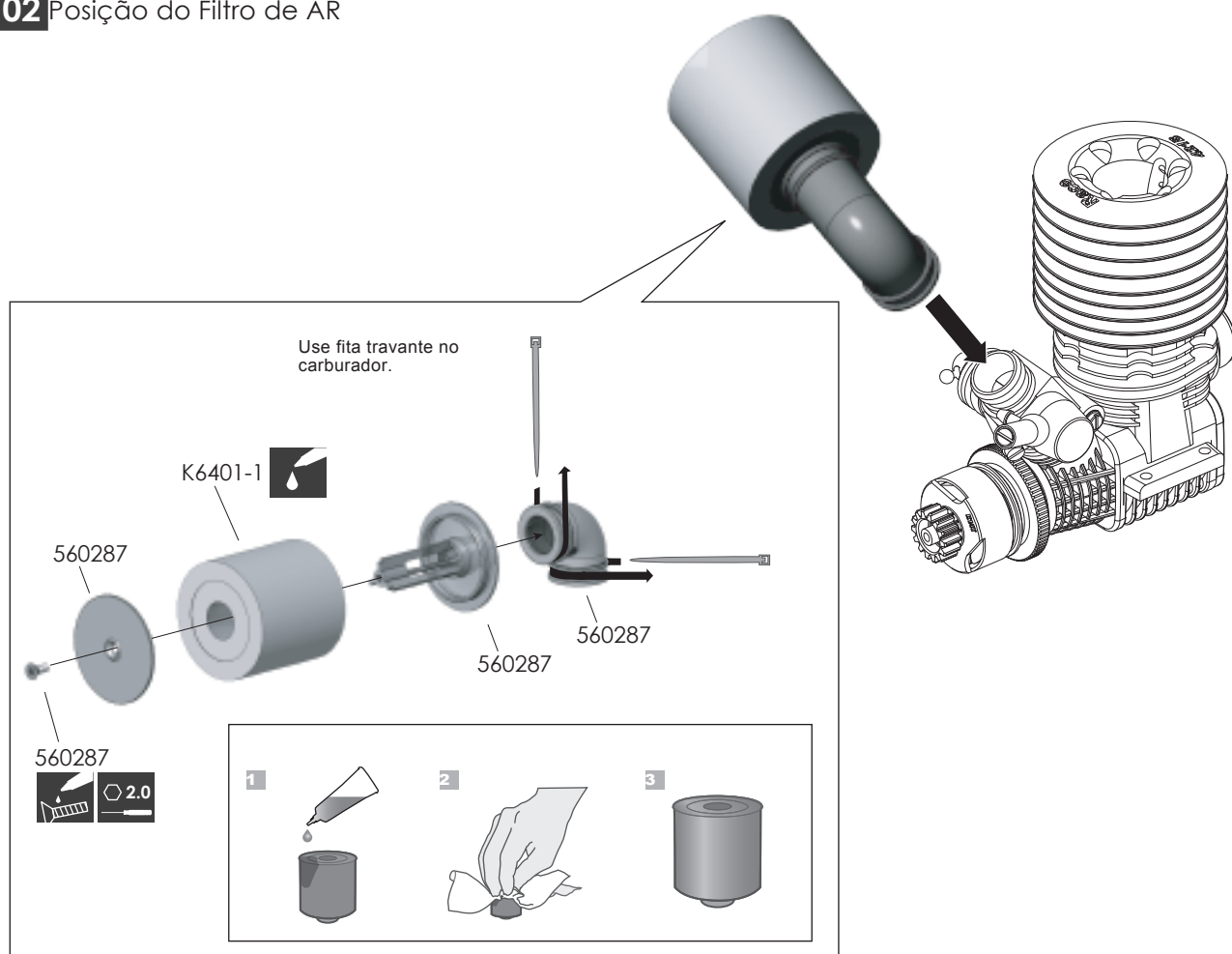

03 Recortar a bolha nas marcações

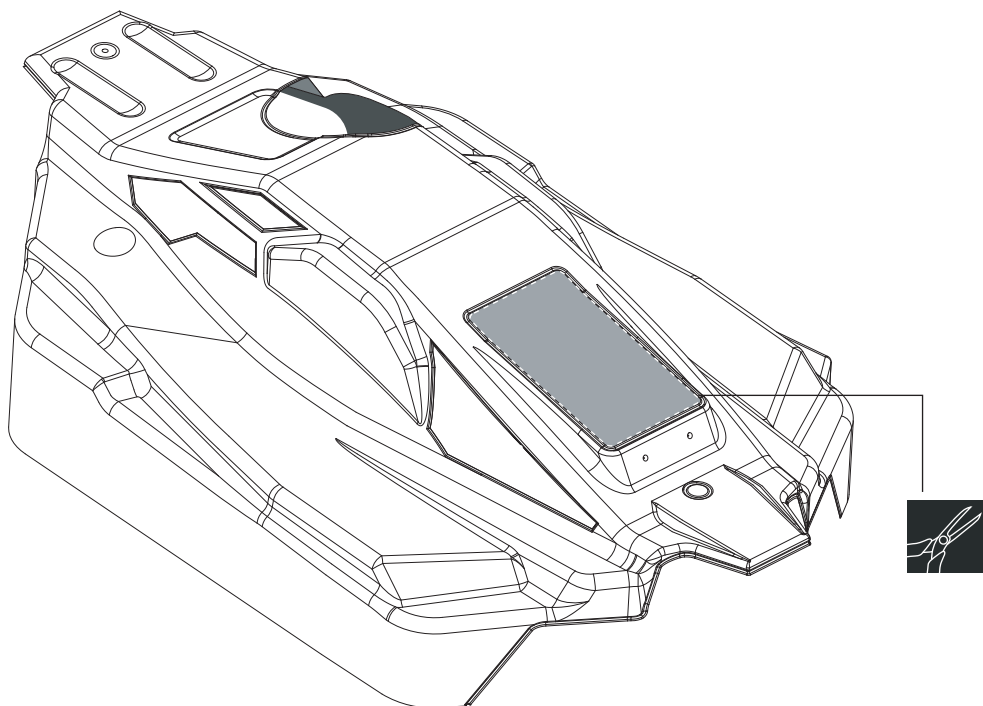

04 Colagem dos adesivos



EXEMPLO

05 Visão Superior dos Adesivos



EXEMPLO

06 Visão Lateral dos Adesivos



EXEMPLO

07 Instalar 4 pilhas modelo AA / Alcalinas.

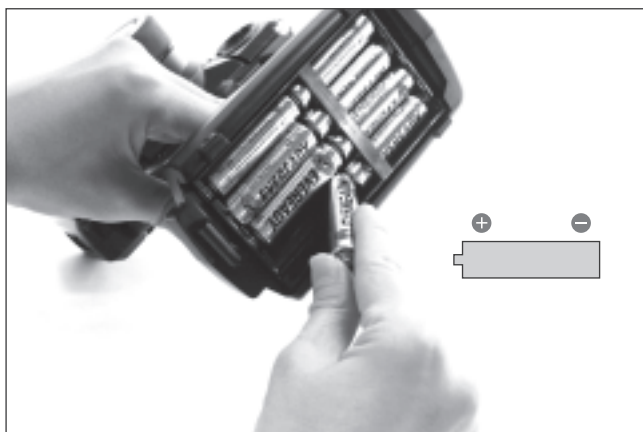

08 É necessário utilizar carregador apropriado para a bateria de do carro. Por favor, note que a bateria é 6V 650mah. Polo positivo (vermelho). Polo Negativo (Preto) Verificar se os conectores estão devidamente bem fixados

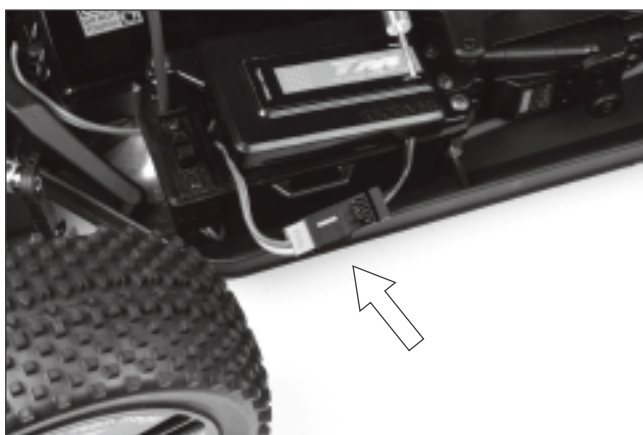
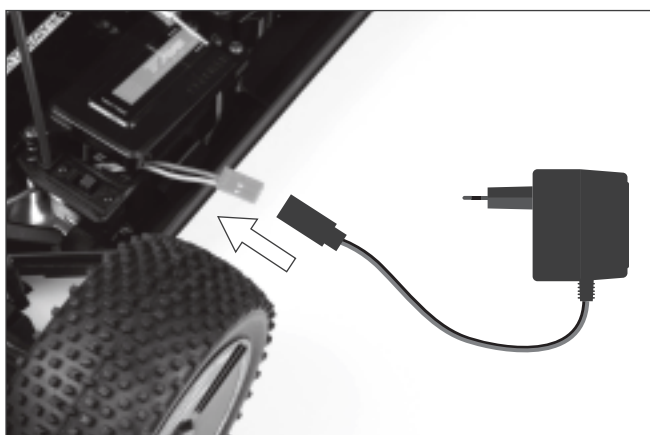

09 Verifique e instale a vela do motor.

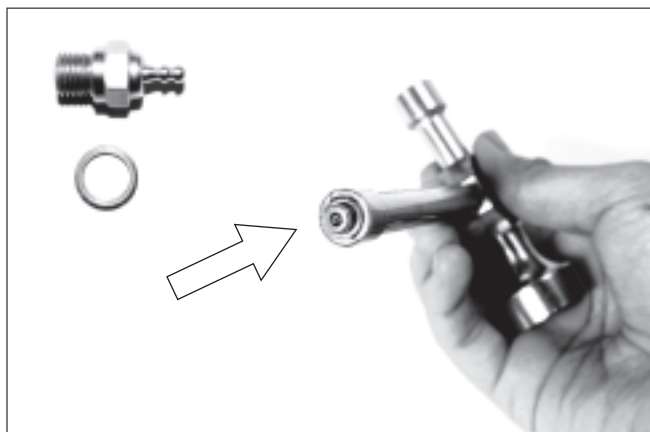

- 10** Após recarregar a bateria do carro e instalar , verifique se estão devidamente conectados. Ligue o radio primeiramente e ligue o botão na posição " ON " do carro. Antes de funcionar o carro, é necessário verificar o alinhamento da direção no radio transmissor, os braços de direção já vem alinhados de fabrica, não é necessário alterar ou regular.

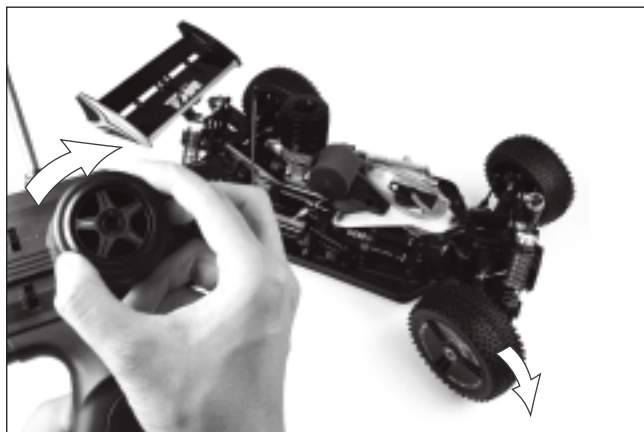
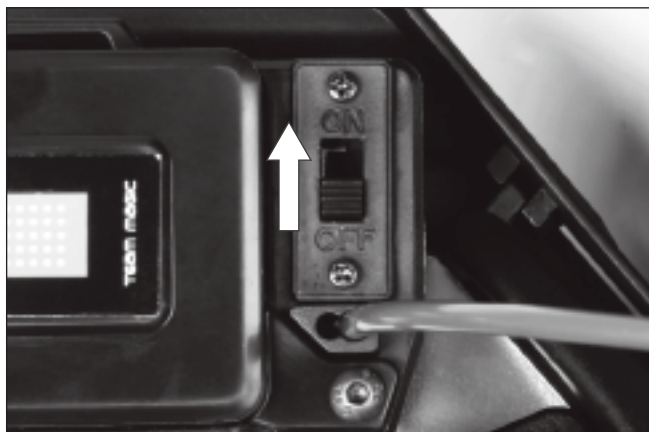

- 11** Abasteça o tanque de combustível Byron Fuels RACE 2000 GEN2 / 20%



- 12** Coloque o aquecedor de velas no motor e aguarde 3 segundos .

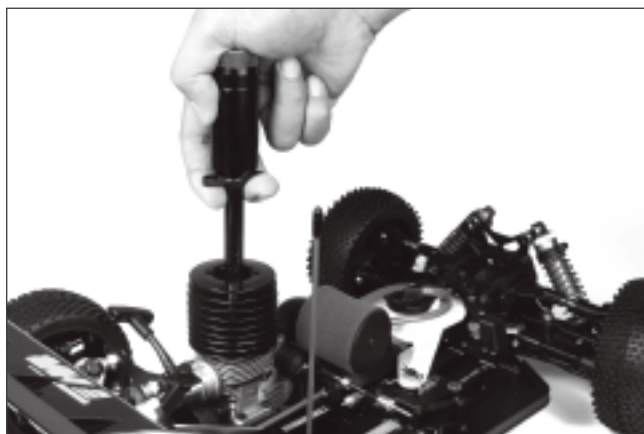

- 13** Puxe a corda de start de forma rápida e constante até que o motor funcione

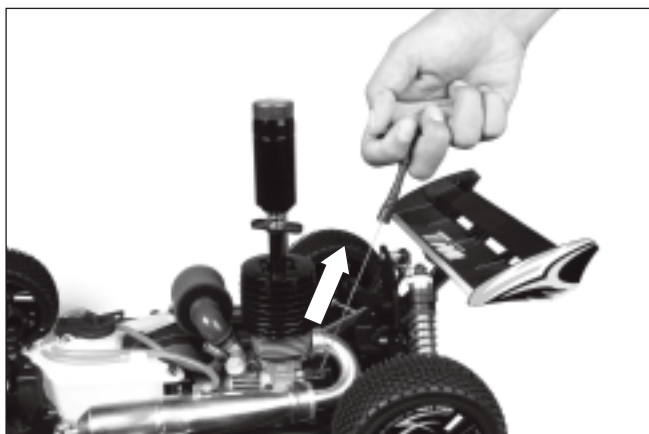

- 14** Após o carro ligado em funcionamento retire o aquecedor de vela e coloque a bolha.



▶ Throttle

▶ Brake



▶ Center Diff

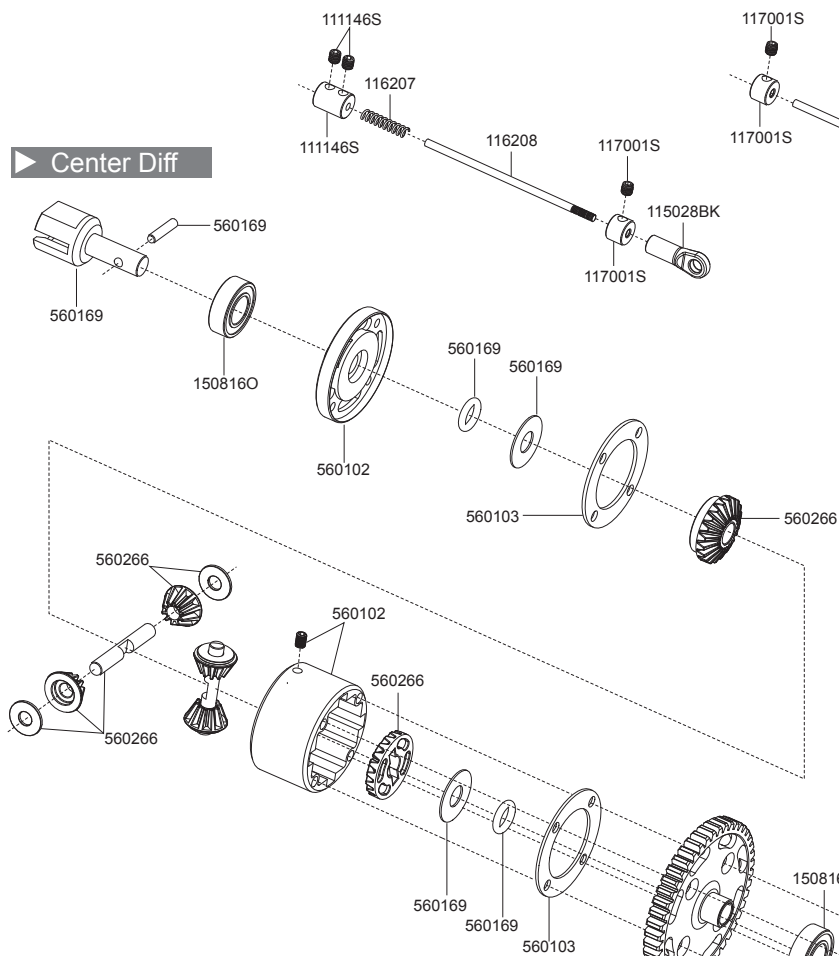

▶ Front/Rear Diff

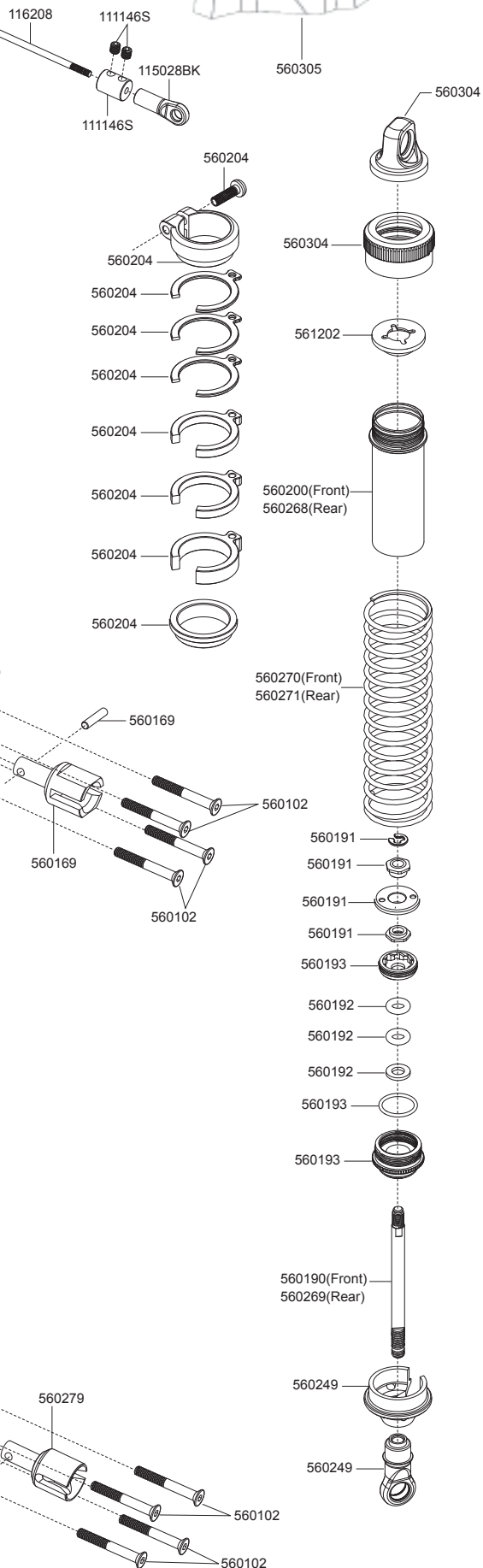
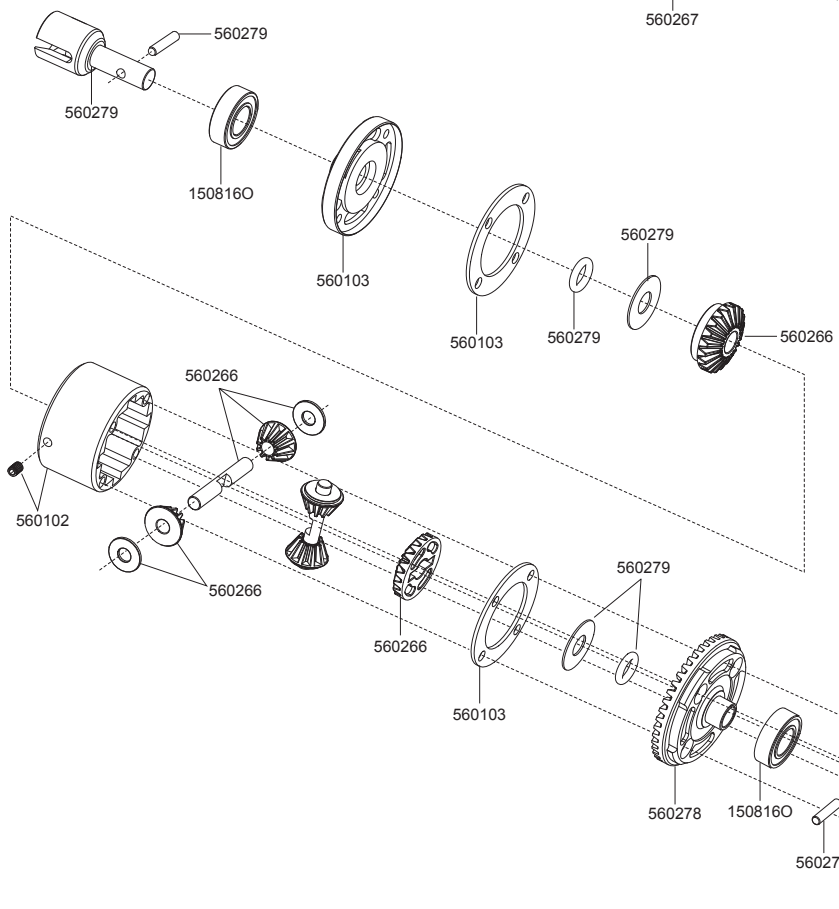

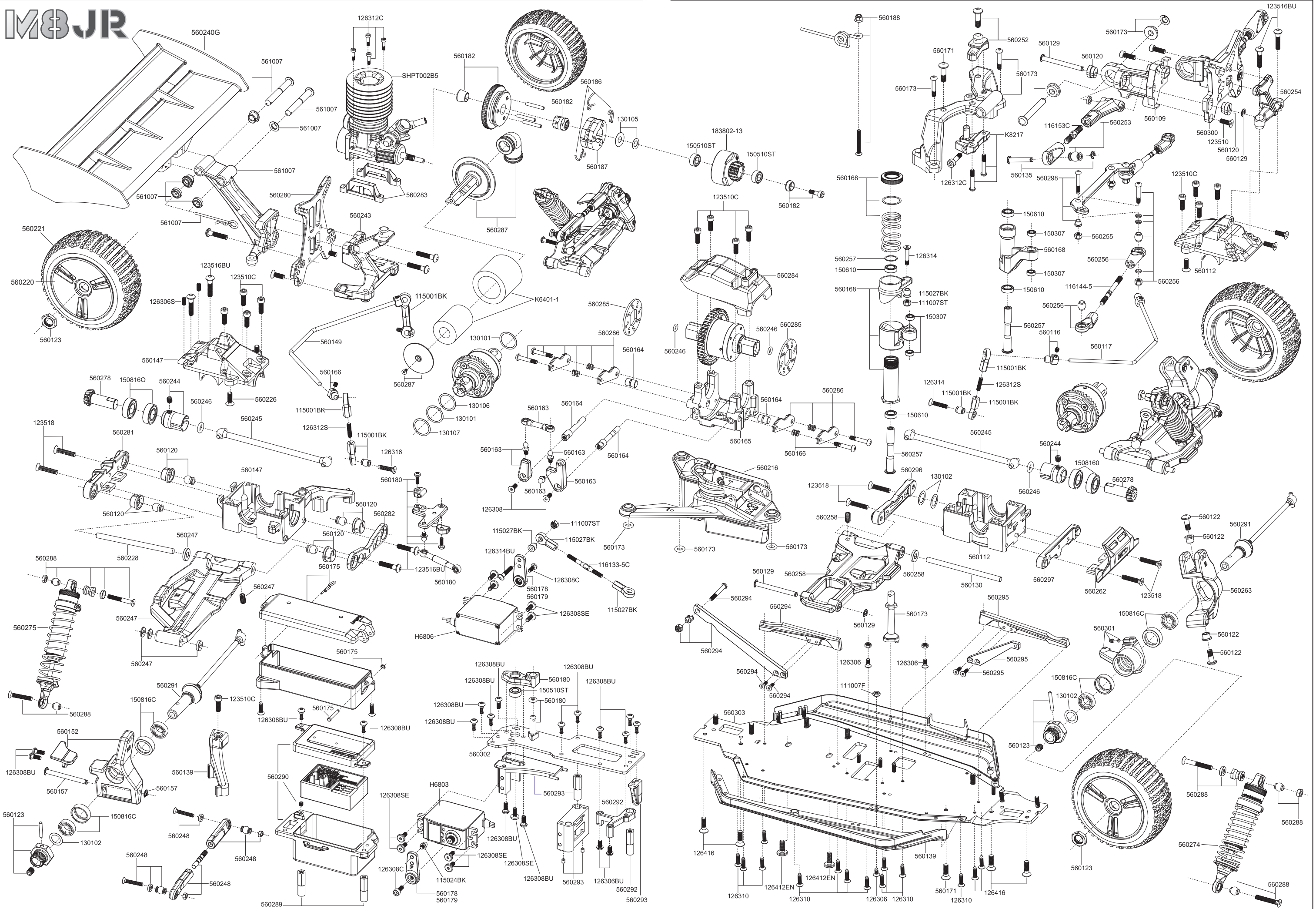



M8 Spare Parts	
Item No.	Item Description
101205	R8 R-Clip (10)
111007	3mm Alum. Locknut (10)
111007F	3mm Flat Locknut (10)
111051	Round Type Fuel Filter (Small)
111118	R5 R-clip (10)
117001	Alum. Stopper (4)
111145S	Small Functional Alum. Antenna Rod Mount (w/antenna rod) Silver
111146S	TM Dual Alum. Stopper (6) Silver
111147F	3.5mm Steel Flat Nut (6)
115001BK	Ball End & 5.8mm Flanged Steel Ball (6) Black
115024BK	4mm Short Thread Ball Stud & Ball Cup (for 3mm rod) (5) Black
115027BK	Ball End & 5.8mm Single Flanged Steel Ball (6) Black
115028BK	Throttle/Brake Ball Cup (4)
116043	Cross Wrench (4, 5, 5.5 & 7mm)
116133-5C	3x35mm CR Adjustable Rod (2)
116144-5	4x45mm Stainless Steel Adjustable Linkage Rod (2)
116153C	5x30mm CR Adjustable Rod (2)
116207	Throttle/Brake Linkage Spring (4)
116208	Throttle/Brake Linkage Rod (4)
116308	3x8mm Steel FH TP Screw (6)
117101	TM Black HC Flare Nut Wrench (2.6, 3.5, 4.5, 6mm)
118009	M8 Sticker (295x210mm)
118010	M1B Zheque Theme Sticker (295x210mm)
123510	3.5x10mm Steel FH Screw (6)
123510C	3.5x10mm Steel Cap Screw (6)
123512C	3.5x12mm Steel Cap Screw (6)
123516BU	3.5x16mm Steel BH Screw (6)
123518	3.5x18mm Steel FH Screw (6)
123522	3.5x22mm Steel FH Screw (6)
126303S	3x3mm Set Screw (6)
126306	3x6mm Steel FH Screw (6)
126306BU	3x6mm Steel BH Screw (6)
126306S	3x6mm Set Screw (6)
126308	3x8mm Steel FH Screw (6)
126308BU	3x8mm Steel BH Screw (6)
126308C	3x8mm Steel Cap Screw (6)
126308SE	3x8mm Steel Flat Round Servo Mount Screw (6)
126310	3x10mm Steel FH Screw (6)
126312	3x12mm Steel FH Screw (6)
126312BU	3x12mm Button Head Screw (6)
126312C	3x12mm Steel Cap Screw (6)
126312S	3x12mm Set Screw (6)
126314	3x14mm Steel FH Screw (6)
126316	3x16mm Steel FH Screw (6)
126412EN	4x12mm Steel Flat Round Engine Mount Screw (6)
126416	4x16mm Steel FH Screw (6)
130101	13.2x15.9x0.22mm Shim (6)
130102	8.1x12x0.2mm Shim (10)
130103	4.2x10x0.2mm Shim (6)
130104	3.6x6.35x1mm (4) & 3.6x6.35x2mm Aluminum Shim (2)
130105	5x9x0.15mm (5), 5x9x0.3mm (3), 5.2x12x0.2mm (2) Shim
130106	13.2x15.9x0.1mm Shim (6)
130107	13.2x15.9x0.5mm Shim (6)
150307	3x7x3mm Bearing (2)
150407	4x7x2.5mm Bearing (2)
150510ST	5x10x4mm Steel Bearing (4)

Item No.	Item Description
150610	6x10x3mm Bearing (2)
150816C	8x16x5mm Composite Bearing (4)
150816O	8x16x5mm Dust-Resistant Bearing (4) Orange
183602-14	TM 14T Super Clutch Bell (mainly for 1/8 buggy)
H6308	H.A.R.D. HS3003 Throttle Servo
H6806	H.A.R.D. HS3305 Steering Servo
K8209	M8 ST Steel F/R Differential Outdrive (1 pair)
K8217	M8 Alum. Front Chassis Stiffener Rod Set
560102	M8 Diff Case Set
560103	M1 Differential Case Gasket (4)
560107	Differential Silicone Oil #7000 (20ml)
560108	Differential Silicone Oil #1000 (20ml)
560109	M8 Front Upper Arm Mount (L & R)
560112	M8 Front Gear Box (1 set)
560116	M8 Hard Anodized Aluminum Anti-Roll Bar Ball Stud (4)
560117	M8 Front Anti-Roll Bar 2.4mm
560120	M8 Hinge Pin Nylon Cap & Adjuster Set
560122	M8 7075 Aluminum Steering Block (1 pair)
560123	M8 Aluminum Wheel Adapter, Pin & Nut (2)
560129	M8 ST Steel 3.5x41.5mm Hinge Pin (for Front Upper/Outside Lower) (2)
560130	M8 ST Steel 4x68.8mm Hinge Pin (for Front Lower/Rear Lower) (2)
560135	M8 ST Steel 3.5x26mm Hinge Pin (for Front Outside Upper) (2)
560137	M8 Hard Coated 3mm 7075 Aluminum Chassis & Center Stiffener
560139	M8 Chassis Guard & Stiffener (1 pair)
560147	M8 Rear Gear Box (1 set)
560149	M8 Rear Anti-Roll Bar 2.8mm
560152	M8 Rear Hub Carrier & Mud Sweeper (1 pair)
560157	M8 ST Steel 3.5x43.5mm Hinge Pin (for Rear Outside Lower) (2)
560163	M8 Brake Lever Set
560164	M8 Hard Coated 7075Aluminum Brake Cam Post & Cam (2pcs/each)
560165	M8 Center Differential Mount (1 set)
560168	M8 Servo Saver Set
560169	M8 ST Steel Center Differential Outdrive (2)
560171	M8 Servo Saver Post Set
560173	M8 Servo Saver Holder & Front Cushion Stiffener Set
560175	M8 Receiver Battery Pack Box
560179	M8 Servo Arm (KO, Sanwa, Airtronics & JR) (2)
560180	M8 Throttle Servo Linkage Set
560182	M8 Clutch Flywheel, Collet & Clutch Nut (for SG shaft)
560183	M8 Receiver Battery Pack Mount
560186	M8 Clutch Spring (3)
560187	M8 Clutch Shoe (3)
560188	M8 Pipe Spring Set
560191	M8 Shock Piston 1.5mm x 2 (2)
560192	M8 Shock O-Ring & Washer (4pcs/each)
560193	M8 Shock End Cap Set (2)
560194	M8 Shock End Cap Tool (2)
560195	M8 Shock Dust-Resistant Wiper (4)
560200	M8 Hard Coated Shock Body 47mm (2)
560203	Shock Silicone Oil #300
560204	M8 Shock Spring Holder & Spacer Set (2)
560216	M8 Fuel Tank
560218	M8 Rear Wing Holding Set
560220	M8 Wheel (2)
560221	M8 Mounted Tire (2)
560226	M8 Bevel Gear Set 43T & 13T
560507	M8 7075Aluminum Rear Lower Rear (2.5 & 3.5 Toe Degree) Hinge Pin Plate

Item No.	Item Description
560555	M8 Shock Piston 1.5mm x 3 (2)
561007	M8 Rear Wing Mount & Holding Set
561202	M8 Neo-Shock Bladder (4)
560178	M8 Servo Arm (Futaba) (2)
560228	ST Steel 4x68.2mm Hinge Pin (for Rear Lower) (2)
560240G	Team Magic Rear Wing Green
560243	Rear Body Mount
560244	ST Steel Small Bevel Gear Outdrive (2)
560245	Hard Coated Alum. 7075 Center Drive Shaft (2)
560246	O-RING P5 (6)
560247	Rear Lower Flying Wing Arm (2)
560248	Rear Upper Linkage Set (2)
560252	Front Body Mount
560253	Front Upper Flying Wing Arm (nylon part only) (2)
560254	Front Shock Tower Stiffener
560256	Steering Rod Nylon Ball End & Steel Ball Set
560257	Steel Servo Saver Post Set
560258	Front Lower Flying Wing Arm (2)
560260	Front Lower Hinge Pin Nylon Cap & Adjuster Set
560262	Front & Rear Nylon Bumper
560263	Steering Block Carrier (1 pair)
560266	Differential Bevel Gear Set (for 1 diff)
560267	46T Main Gear
560268	Hard Coated Rear Shock Body (2)
560269	ST Steel 4x65.4mm Rear Shock Shaft (2)
560270	Front 18x66mm Shock Spring (2) White
560271	Rear 18x86mm Shock Spring (2) White
560272	Front/Rear Differential Set (1 set)
560273	Center Differential Set (1 set)
560274	Front Shock Absorber Set
560275	Rear Shock Absorber Set
560276	Shock Silicone Oil #400
560278	New Bevel Gear Set 43T & 13T
560280	M8J Alum. Rear Shock Tower
560281	Composite Rear (Rear) Lower Hinge Pin Plate(2.5 & 3.5 Toe Degree)
560282	Composite Rear (Front) Lower Hinge Pin Plate(2.5 & 3.5 Toe Degree)
560283	M8J Engine Mount (2)
560284	M8 Center Differential Mount (1 set)
560285	M8J Brake Disc (2)
560286	M8J Brake Plate & Brake Pad
560287	M8J Air Filter
560288	M8J Shock Ball End, Spring Cap & Hardware Set (2)
560289	M8J Radio Plate Support (Hex)
560290	M8J New Large Receiver Box
560291	M8J Front/Rear CVA Joints (2)
560292	M8J Transponder Mount (Hex Post Included)
560293	M8J Servo Mount Set
560294	M8J Rear Chassis Stiffener Rod Set
560295	M8J Front Chassis Stiffener Rod Set
560296	M8J Composite Front (Rear) Lower Hinge Pin Plate
560297	M8J Composite Front (Front) Lower Hinge Pin Plate
560298	M8J One Piece Steering Linkage Set
560300	M8J Alum. Front Shock Tower
560301	M8J Front Steering Block Set (2)
560302	M8J Upper Deck
560303	M8J Alum. Chassis

SHTP002B5	SH 21 Pullstart Engine
-----------	------------------------

M8 Optional Parts	
Item No.	Item Description
560304	M8J Shock Cap Set
560305	M8J Clear Body
560158	M8 7075 Aluminum Rear Lower Rear (1 & 2 Toe Degree) Hinge Pin Plate
560165	M8 Center Differential Mount (1 set)
560185	M8 One-Piece Engine Mount
560177	M8 Servo Moun
560242	Rear Alum. 7075 Shock Tower
560250	Lightweight Engine Mount (2)
560255	One Piece Alum. 7075 Steering Linkage Set
560264	Alum. 7075 Rear Chassis Stiffener Set
560265	Aluminum Shock Cap (2)
560501	M8 7075 Aluminum Rear Lower Front (1.5 & 2.5 Anti-Squat Degree) Hinge Pin Plate
560505	M8 7075 Aluminum Rear Lower Rear (1.5 & 2.5 Toe Degree) Hinge Pin Plate
560506	M8 7075 Aluminum Rear Lower Rear (3 & 4 Toe Degree) Hinge Pin Plate
560510	Servo Saver Spring (1.4mm) Green
560511	Servo Saver Spring (1.5mm) Blue
560530	M8 Front Anti-Roll Bar 2.3mm Yellow
560531	M8 Front Anti-Roll Bar 2.5mm Blue
560535	M8 Rear Anti-Roll Bar 2.7mm Purple
560536	M8 Rear Anti-Roll Bar 2.9mm Black
560556	M8 Shock Piston 1.5mm x 4 (2)
560570	M8 Adjustable Brake Linkage Set
110004F	X5 Turbo 2 Starter Box (Off-road, pre-assembled)
114052	IB 6v-1400mah Ni-MH Receiver Pack (Turbo 35 approved)
114055	6v-1400mah Ni-MH Receiver Pack (Turbo 35 approved)
114062	6v-1100mah Ni-MH Lightweight Rectangle Receiver Pack (AAA size)
114203-43	Black Magic Metered Glow Starter w/GP 4300mah Battery
116006	Curved Model Scissors
116025	Cross Wrench (7, 8, 10, 12 & 17mm)
116052	TM 1/8 Setup Board (500x480mm)
117002-1M	TM Black HC Hex Wrench Metric Size 1.5mm
117002-2M	TM Black HC Hex Wrench Metric Size 2.0mm
117002-3M	TM Black HC Hex Wrench Metric Size 2.5mm
117002-4M	TM Black HC Hex Wrench Metric Size 3.0mm
117006	TM Black HC Pivot Ball Nut Hex Wrench 5mm
117009	TM Black HC Metric Ball Stud Nut Driver 5mm
117010	TM Black HC Nut Driver 5.5mm (for 3mm nut)
117012	TM Black HC Nut Driver 8mm (for glow plug & 5mm nut)
117013	TM Black HC Push Type Clutch Nut Driver 10mm
117023	TM Black HC Carb Tuning Slotted Screw Driver (4mm)
119206	TM Transmitter Bag (Black)
119213	TM Starter Box Bag - Large (Black)
119220	TM New Formula 8 (F8) Car Bag (for 1/8 cars)
119223	TM Racing T Shirt (Orange)
119224	TM Racing T Shirt (Black)
183602-12	TM 12T Super Clutch Bell (mainly for 1/8 buggy)
183602-13	TM 13T Super Clutch Bell (mainly for 1/8 buggy)
183602-15	TM 15T Super Clutch Bell (mainly for 1/8 buggy)
183602-16	TM 16T Super Clutch Bell (mainly for 1/8 buggy)
183602-17	TM 17T Super Clutch Bell (mainly for 1/8 buggy)
183602-18	TM 18T Super Clutch Bell (mainly for 1/8 buggy)

Date: _____ Driver: _____
 Event: _____ Car: _____
 Track: _____ Weight: _____

STANDARD

SETUP SHEET



TRACK CONDITIONS

Surface: ☐ Smooth ☒ Med. ☐ Bumpy
 Size: ☐ Open ☒ Med. ☐ Tight
 Traction: ☐ High ☒ Med. ☐ Low

Track Temp/Air Temp: _____° / _____°

Note: _____

FRONT SUSPENSION

Shocks

Shock Length **90** mm

Oil **500** wt

Pison **Ø 1.5**

Spring **White**

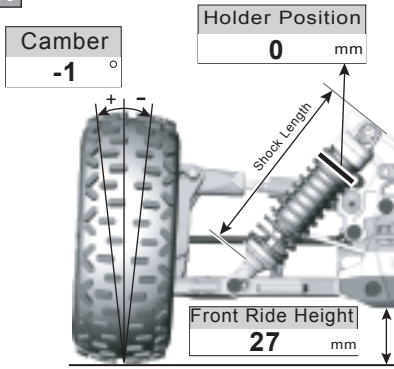

REAR SUSPENSION

Shocks

Shock Length **105** mm

Oil **400** wt

Pison **Ø 1.5**

Spring **White**

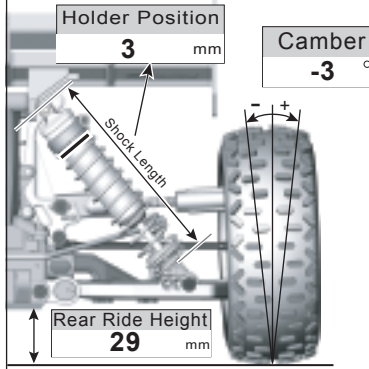

FRONT SUSPENSION

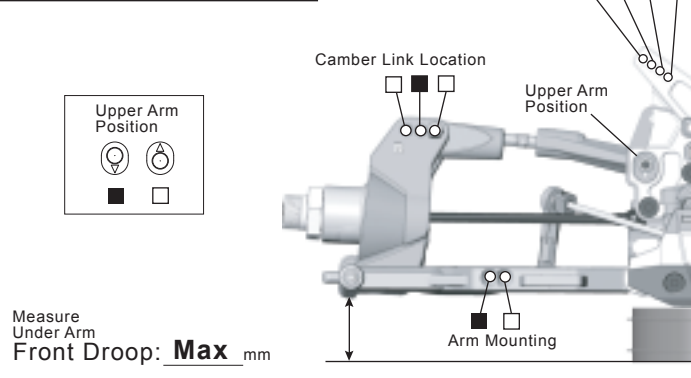

REAR SUSPENSION

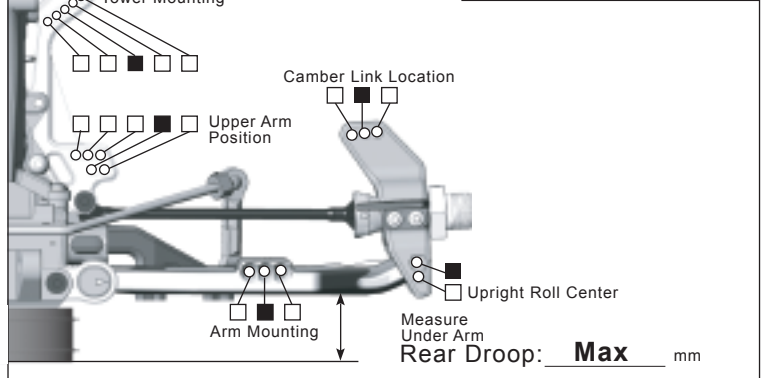

FRONT SUSPENSION

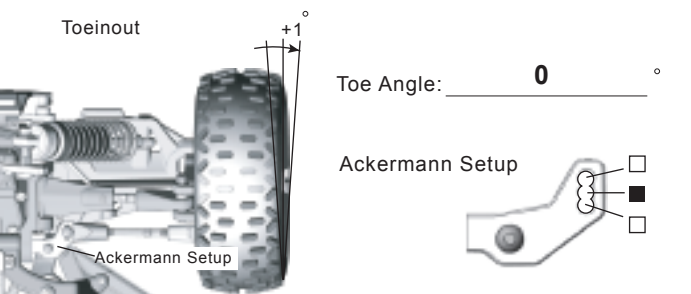

REAR SUSPENSION

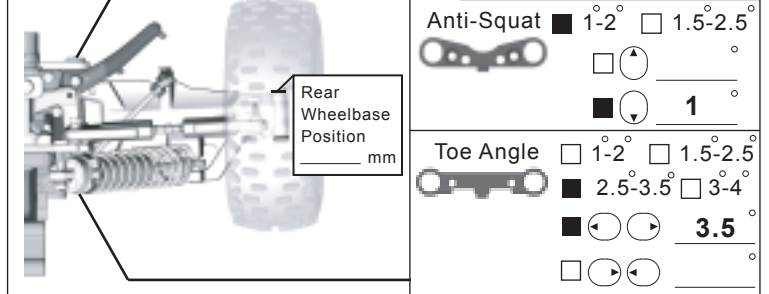

ENGINE

Gear Ratio **14** T / **46** T
 Clutch Spring _____ mm Air Filter _____
 Clutch Shoe _____ Plug _____
 Engine _____ Manifold _____
 Gasket _____ mm Muffler _____
 Reducer _____ Fuel _____

TIRE

Front Rear
 Type _____
 Inserts _____
 Wheels _____

WING

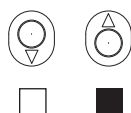

DIFF OIL

Front **7000** wt Other _____
 Center **5000** wt Other _____
 Rear **2000** wt Other _____

ANTI ROLL BAR

FRONT **2.4** /mm REAR **2.8** /mm
 Thickness/mm

COMMENTS

Race Time / Lap: _____
 Best Lap Time: _____
 Position: _____
 Notes: _____

Date: _____ Driver: _____
 Event: _____ Car: _____
 Track: _____ Weight: _____

SETUP SHEET



TRACK CONDITIONS

Surface: ☐ Smooth ☐ Med. ☐ Bumpy
 Size: ☐ Open ☐ Med. ☐ Tight
 Traction: ☐ High ☐ Med. ☐ Low

Track Temp/Air Temp: _____° / _____°

Note: _____

FRONT SUSPENSION

Shocks

Shock Length _____ mm

Oil _____ wt

Pison \emptyset _____

Spring _____

Camber

Holder Position _____ mm

Shock Length _____ mm

Front Ride Height _____ mm

REAR SUSPENSION

Shocks

Shock Length _____ mm

Oil _____ wt

Pison \emptyset _____

Spring _____

Camber

Holder Position _____ mm

Shock Length _____ mm

Rear Ride Height _____ mm

FRONT SUSPENSION

Tower Mounting ☐ ☐ ☐ ☐ ☐ ☐

Camber Link Location ☐ ☐ ☐ ☐

Upper Arm Position ☐ ☐

Arm Mounting ☐ ☐

Measure Under Arm Front Droop: _____ mm

REAR SUSPENSION

Tower Mounting ☐ ☐ ☐ ☐ ☐ ☐

Camber Link Location ☐ ☐ ☐ ☐

Upper Arm Position ☐ ☐

Arm Mounting ☐ ☐

Upright Roll Center ☐

Measure Under Arm Rear Droop: _____ mm

FRONT SUSPENSION

Toeinout $+1^\circ$

Toe Angle: _____°

Ackermann Setup ☐ ☐ ☐ ☐

REAR SUSPENSION

Anti-Squat ☐ 1-2° ☐ 1.5-2.5°

Toe Angle ☐ 1-2° ☐ 1.5-2.5°

☐ 2.5-3.5° ☐ 3-4°

ENGINE

Gear Ratio _____ T / _____ T

Clutch Spring _____ mm Air Filter _____

Clutch Shoe _____ Plug _____

Engine _____ Manifold _____

Gasket _____ mm Muffler _____

Reducer _____ Fuel _____

TIRE

	Front	Rear
Type	_____	_____
Inserts	_____	_____
Wheels	_____	_____

WING

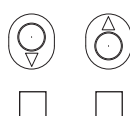

DIFF OIL

Front _____ wt Other _____

Center _____ wt Other _____

Rear _____ wt Other _____

ANTI ROLL BAR

FRONT _____ /mm

REAR _____ /mm

Thickness/mm

COMMENTS

Race Time / Lap: _____

Best Lap Time: _____

Position: _____

Notes: _____

MBJR



Cuidados !

Para prevenir sérios acidentes e graves ferimentos, é importante ler atenciosamente o manual de instruções. Isso não é brinquedo, recomendado para maiores de 15 anos

Leia atentamente o seu manual de instruções

- Não use o automodelo em ruas e avenidas, pode causar acidentes de trânsito ou pedestres
- Não use o automodelo perto de crianças e animais
- Não use dentro de casa, pode causar incêndio
- Não use perto de hospitais, pode causar barulho e perturbar enfermos

Verifique com frequência o filtro de AR do automodelo, limpe e coloque óleo de filtro de AR.

Verifique com frequência seu rádio transmissor, se não há modelos iguais por perto para dar interferência

Verifique com frequência a carga da bateria do carro e as pilhas do rádio para não haver perda de controle. Verifique com frequência os freios e o acelerado para evitar problemas com o automodelo

Nunca use GASOLINA automotiva em seu automodelo, causa danos irreparáveis.

Utilize sempre o combustível BYRON FUELS RACE 2000 GEN 2 - 20% Nitrometano e 12% Óleo

Nunca armazene combustível próximo a locais quentes e seco.

Mantenha combustível fora do alcance de crianças





THE POWER OF TEAM MAGIC

Team Magic Model Industrial co. Ltd.

No.185-2, 38th Road, Taichung industrial Park, Taichung, Taiwan 407

E-mail: service@teammagic.com.tw

Web: www.teammagic.com.tw

Tel: 886-4-23552606 Fax: 886-4-23552946

MADE IN TAIWAN



60982

